

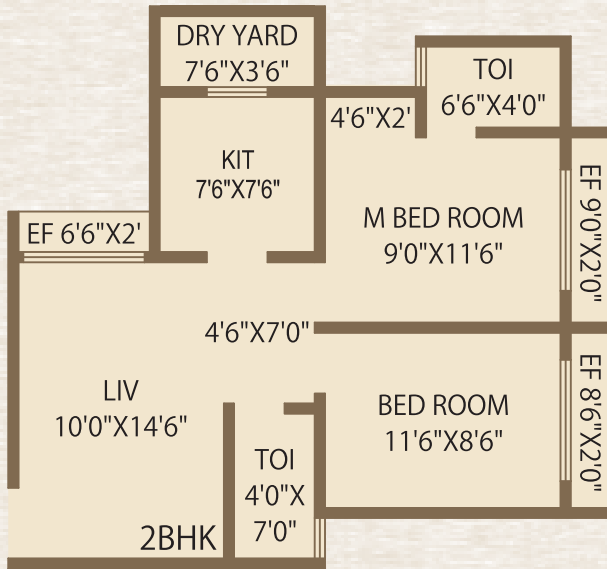

Property
Investment
Now So
Simple

with Option to Purchase



▶ Invest 50% of Flat Cost ◀

Get Rent

Rs. 10,100/-
Monthly

Area Description	Value
RERA CARPET	= 556.46
ELEVATION FEATURES	= 47.14
970 TOTAL USEABLE AREA	= 603.30
STAIR+LOBBY+OTHER	= 366.70
TOTAL CONSTRUCTION AREA	= 970.00

Proposed Launching On or before 18 Months - Rs. 58.68 Lacs Minimum.

Investor's privilege Price - Rs.48.50 Lacs - till Completion of Plinth

Investment Amount (50%) Rs.24,25,000/-	Receive Monthly Rs.10,104/- through 18 PDCs	Min Gross Sale Benefit Rs.10.18 Lacs	Total Received by Monthly Benefit Rs.1.81 Lacs (A)	Net Sale Benefit 50:50 Rs.8.36 Lacs	Investor's Profit Share Rs.4.18 Lacs (B)	Developer's Profit Share Rs.4.18 Lacs
---	--	---	---	--	---	--

Investor's Minimum Net Benefit Rs.6.00 Lacs (A+B)

घर हो तो ऐसा®

Original... Since 1998

*Above Figures and Plan are Indicative, only for investors survey before launch of fully furnished flat.